



MARQUE: JBL
REFERENCE: HORIZON NOIR
CODIC: 4078411



NOTICE
↓

Horizon

Quick Start Guide

Guide de démarrage rapide

EN

- Bluetooth® version: 4.1
- Support: A2DP V1.2, AVRCP V1.0
- Transducer: 2 x 45mm
- Rated power input: 2 x 5W
- Frequency response: 70Hz - 20kHz
- Max SPL: 82.5dB (@1m)
- Power adaptor: 13VDC, 2.2A
- USB output: 5V, 1A (max.) x 2
- FM frequency: 76 - 108 MHz
(Receiving ranges vary by region)
- Bluetooth® transmitter power: 0-4 dBm
- Bluetooth® transmitter frequency range: 2.402 – 2.480 GHz
- Bluetooth® transmitter modulation: GFSK, $\pi/4$ DQPSK, 8DPSK
- Dimension (H x W x D): 162 x 183 x 81 (mm)
- Weight: 890 g

FR

- Version Bluetooth® : 4.1
- Support : A2DP V1.2, AVRCP V1.0
- Transducteur : 2 x 45 mm
- Puissance d'entrée nominale : 2 x 5 W
- Réponse en fréquences : 70 Hz - 20 kHz
- Pression sonore max. : 82,5 dB (à 1 m)
- Adaptateur électrique : 13 VCC, 2,2 A
- Sortie USB : 5 V, 1 A (max.) x 2
- Fréquence FM : 76 - 108 MHz
(les bandes de réception varient selon la région)
- Puissance de l'émetteur Bluetooth® : 0-4 dBm
- Plage de fréquences de l'émetteur Bluetooth® : 2,402 – 2,480 GHz
- Modulation de l'émetteur Bluetooth® : GFSK $\pi/4$ DQPSK 8DPSK
- Dimensions (H x L x P) : 162 x 183 x 81 (mm)
- Poids : 890 g



Horizon



Horizon

Quick Start Guide
Guide de démarrage rapide

1 What's in the box

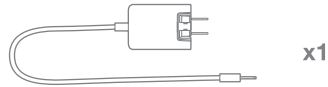
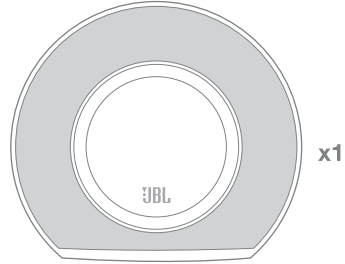

Horizon

Quick Start Guide
Guide de démarrage rapide

2 Buttons

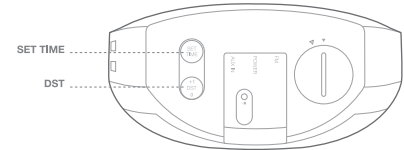
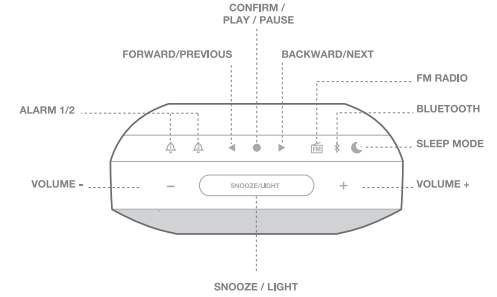

Horizon

Quick Start Guide
Guide de démarrage rapide

3 Connections

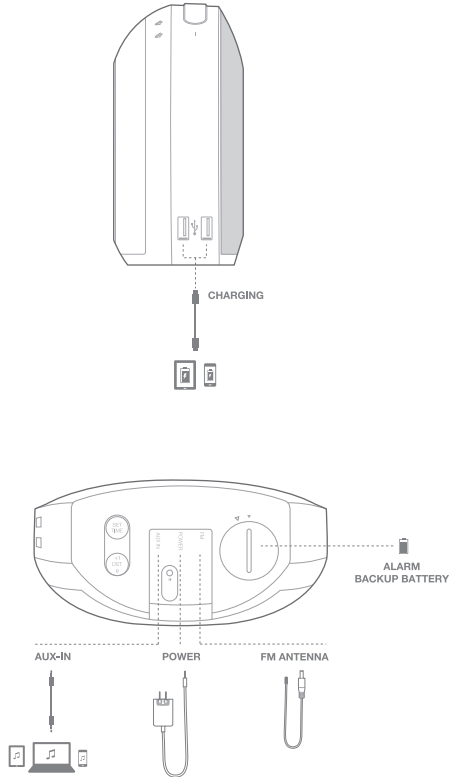

Horizon

Quick Start Guide
Guide de démarrage rapide

4 Set Time

1. 12Hr/24Hr

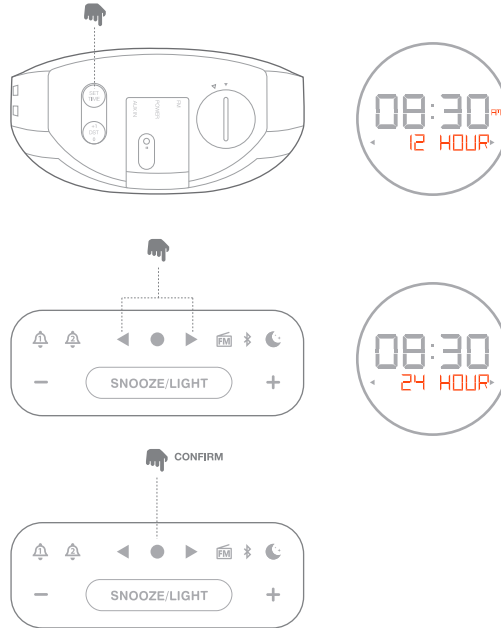

2. Time
3. Date

Horizon

Quick Start Guide
Guide de démarrage rapide

5 Bluetooth®

A. Connect Bluetooth®

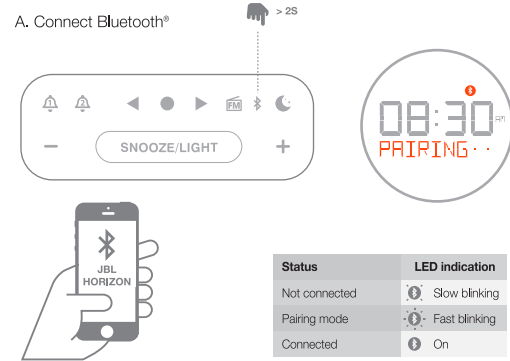

B. Music playback

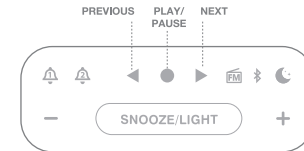

6 Light



Horizon

Quick Start Guide
Guide de démarrage rapide

7 Alarm

A. Set Alarm

1. Time

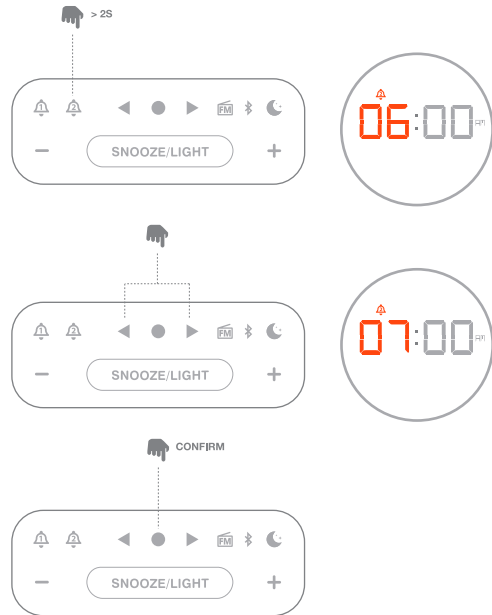

2. Weekday / Weekend / Everyday / One day
3. Ringtone
4. Light

Horizon

Quick Start Guide
Guide de démarrage rapide

B. On / Off

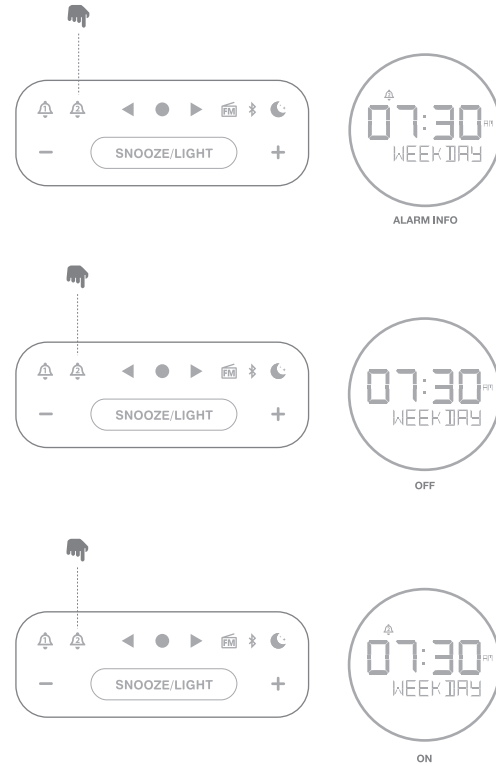

Horizon

Quick Start Guide
Guide de démarrage rapide

C. Ringing

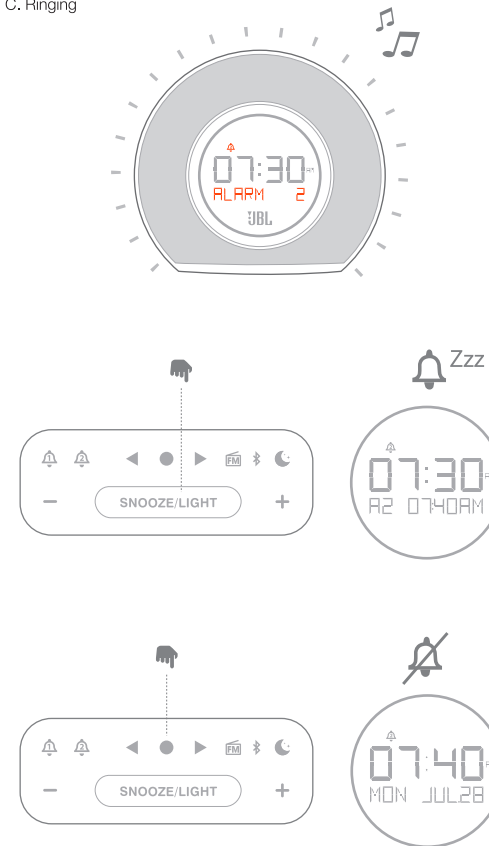

Horizon

Quick Start Guide
Guide de démarrage rapide

D. Snooze Settings

1. Snooze time

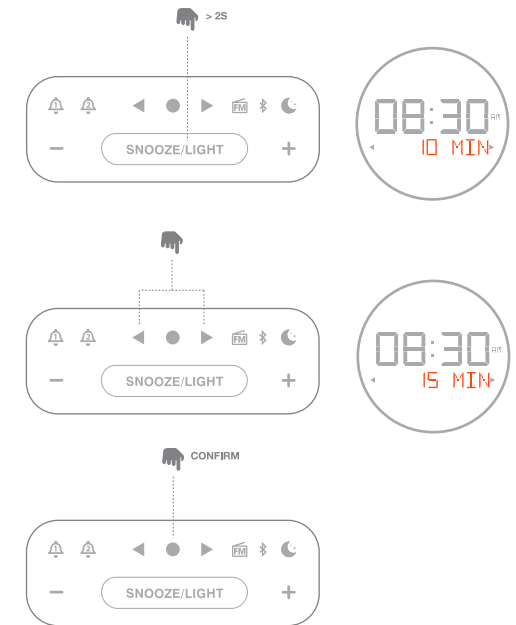

2. Alarm 1 / Alarm 2 / Alarm 1 and 2

Horizon

Quick Start Guide
Guide de démarrage rapide

8 FM Radio

A. Listen to FM

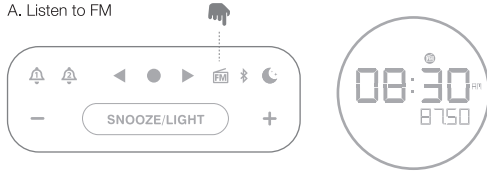

B. Tune

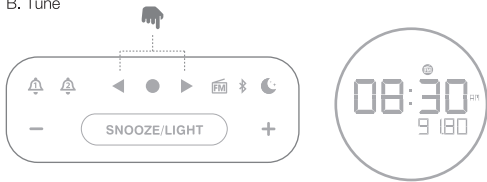

C. Scan

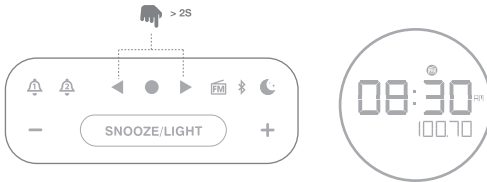

D. Listen to Presets

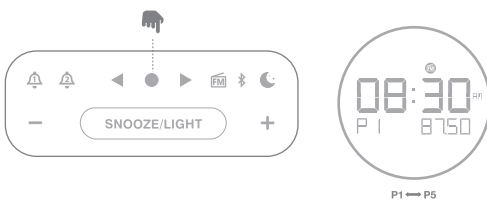

P1 ↔ P5

Horizon

Quick Start Guide
Guide de démarrage rapide

E. Set preset station

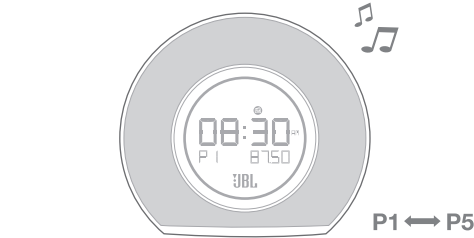

P1 ↔ P5

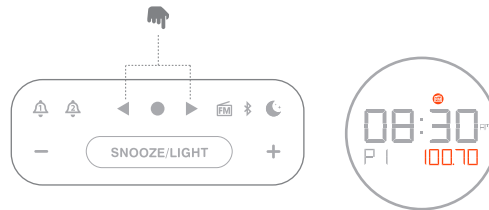
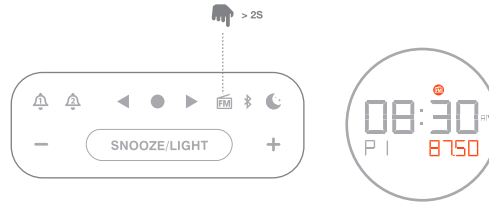

CONFIRM

Horizon

Quick Start Guide
Guide de démarrage rapide

F. Save as preset



STATION

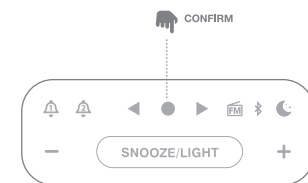
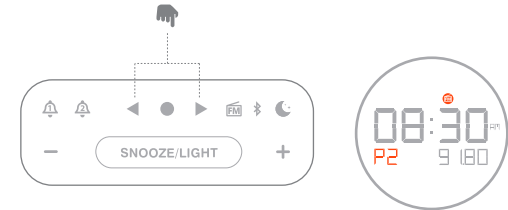
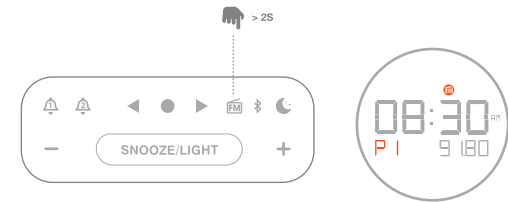

CONFIRM

Horizon

Quick Start Guide
Guide de démarrage rapide

9 Sleep mode

A. Sleep mode settings

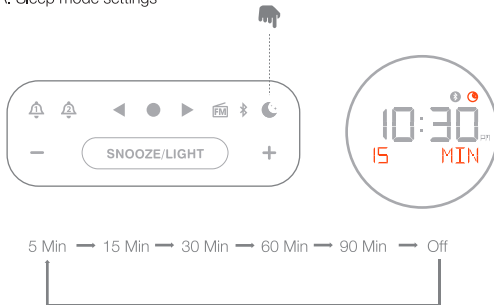

B. Check sleep time

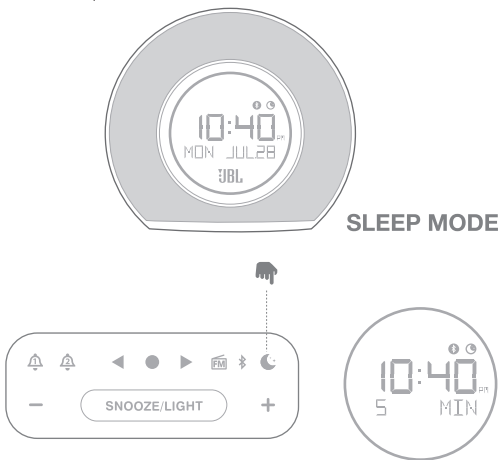

Horizon

Quick Start Guide
Guide de démarrage rapide

10 Display on / off

